



100% SUBMITTAL

UNINTECH CONSULTING ENGINEERS, INC.
3737 EXECUTIVE CENTER DR. #101 TBPE Reg. No. F-5499
AUSTIN, TEXAS 78731
PHONE: 512.579.0722 FAX: 512.579.0734 WWW.UNINTECH.COM

LEGEND

- PROPOSED TRAFFIC FLOW DURING DETOUR
- ↑ SIGN
- TYPE III BARRICADE

- NOTES:
- REFER TO TXMUTCD, FIGURE 6H-19 "DETOUR FOR ONE TRAVEL DIRECTION (TA-19)" AND TXDOT BARRICADE AND CONSTRUCTION STANDARDS FOR TCP SIGNS PLACEMENT.
 - REFER TO TXDOT BC STANDARD SHEETS FOR ADVANCED WARNING SIGNS PLACEMENT.

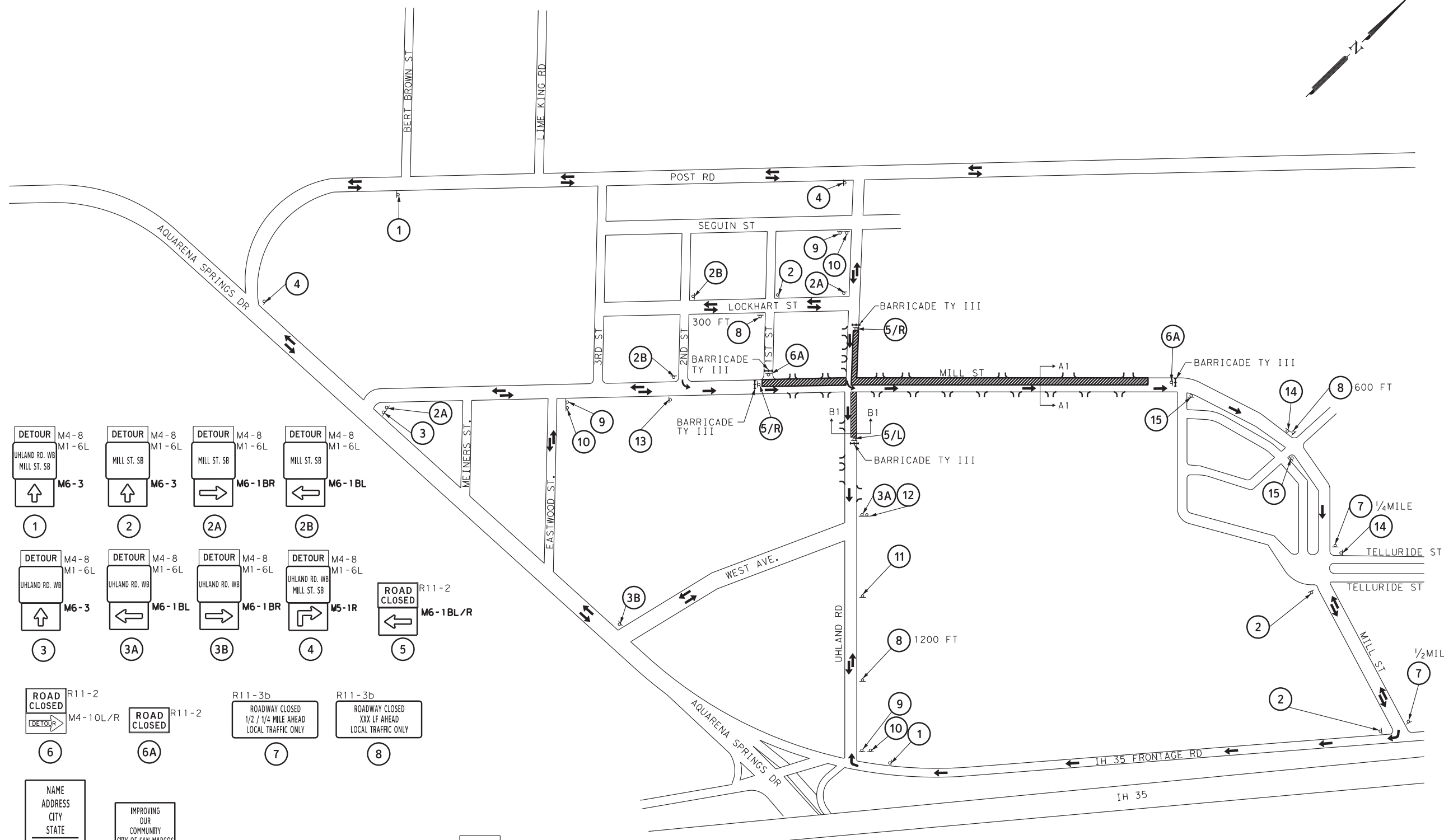

DETOUR M4-8 UHLAND RD. WB M1-6L M6-3 1	DETOUR M4-8 MILL ST. SB M1-6L M6-3 2	DETOUR M4-8 MILL ST. SB M1-6L M6-1BR 2A	DETOUR M4-8 MILL ST. SB M1-6L M6-1BL 2B	DETOUR M4-8 UHLAND RD. WB M1-6L M6-3 3	DETOUR M4-8 UHLAND RD. WB M1-6L M6-1BL 3A	DETOUR M4-8 UHLAND RD. WB M1-6L M6-1BR 3B	DETOUR M4-8 UHLAND RD. WB MILL ST. SB M1-6L M5-1R 4	ROAD CLOSED R11-2 M6-1BL/R 5	ROAD CLOSED R11-2 M4-10L/R 6	ROAD CLOSED R11-2 6A	ROADWAY CLOSED R11-3b 1/2 / 1/4 MILE AHEAD LOCAL TRAFFIC ONLY 7	ROADWAY CLOSED R11-3b XXX LF AHEAD LOCAL TRAFFIC ONLY 8	NAME ADDRESS CITY STATE CONTRACTOR SCHEDULED START MONTH, YEAR SCHEDULED COMPLETION MONTH, YEAR 9	IMPROVING OUR COMMUNITY CITY OF SAN MARCOS MILL STREET RECONSTRUCTION PROJECT FOR INFORMATION CALL 512-393-8150 OR VISIT WWW.SANMARCOS.TX.GOV/CONSTRUCTION 10	DETOUR AHEAD CW20-2D 11	ROAD CLOSED TO THRU TRAFFIC R11-4 M6-1BL 12	DETOUR M4-8 1ST. ST. LOCKHART ST. M5-1L 13	DETOUR M4-9L 14	DETOUR M4-9R 15
--	--	---	---	--	---	---	--	--	--	-----------------------------------	--	--	---	---	--------------------------------------	---	---	------------------------------	------------------------------

DETOUR LAYOUT PHASE - I
NOT TO SCALE

SCALE: N. T. S.

REV	DESCRIPTION	BY	DATE

7/25/2018
YUE ZHU
85643
REGISTERED PROFESSIONAL ENGINEER
7/25/2018

MILL STREET
DETOUR LAYOUT PHASE I

Project No	C539
CS#	-
Client I.D.	XXXXXX
Drawn By	I.Z.M.
Checked By	Y. Z.
Scale	AS SHOWN
Date	7/25/2018
Sheet	1 of 1
Sheet No.	22

7/25/2018 3:31:05 PM T:\2016\16-003-W Mill Street\TCP\MILL ST*TCP-DETOUR.dgn